



INSTALLATION



AIRMASTER™ DRAGON WINGS™ 1388

VENTED WIND DIRECTORS

FITS: ALL '01-UP GL1800 MODELS

PARTS INCLUDED

- 1 Upper Vent, Right
- 1 Upper Vent, Left
- 1 Right Dragon Wing
- 1 Left Dragon Wing
- 1 Hardware Kit Including:
 - 4 Short Mounting Brackets
 - 2 Long Mounting Brackets
 - 6 1/4-20 x 5/8" Pan Head Screws (PHS)
 - 6 1/4-20 Locking Nuts
 - 2 M5 x .08 x 25 Pan Head Screws (PHS)
 - 2 M5 Flat Washers
 - 2 Nylon Spacers
- 1 Installation Instructions

Please read and understand entire instructions before starting installation.

THANK YOU FOR CHOOSING KÜRYAKYN!

IN ORDER TO PROTECT YOU AND OTHERS FROM POSSIBLE INJURY AND/OR PROPERTY DAMAGE OR LOSS, PLEASE PAY CLOSE ATTENTION TO ALL INSTRUCTIONS, WARNINGS, CAUTIONS AND ATTENTION NOTES REGARDING THE USE AND CARE OF THIS PRODUCT.

WARNING! THIS INDICATION ALERTS YOU TO THE FACT THAT IGNORING THE CONTENTS DESCRIBED HEREIN CAN RESULT IN POTENTIAL DEATH OR SERIOUS INJURY.

CAUTION! This indication alerts you to the fact that ignoring the contents described herein can result in potential injury or material damage.

ATTENTION! This indication alerts you to the fact that ignoring the contents described herein may negatively affect product performance and functionality.

TOOLS SUGGESTED

Set of hex wrenches, Phillips screwdriver, combination wrenches.

STRICTLY OBSERVE THE FOLLOWING GUIDELINES IN ORDER TO USE THE PRODUCT PROPERLY AND AVOID POTENTIALLY DANGEROUS ACCIDENTS.

PROCEDURE

STEP 1 Read and understand all steps in the instructions before starting the installation. Park the motorcycle on a hard, level surface and turn off the ignition.

-cont.-

CUSTOMER SERVICE

877.370.3604 (toll free)

INSTALLATION QUESTIONS

techsupport@kuryakyn.com
or call 715.247.2983

LIMITED WARRANTY

Kuryakyn warrants that any Kuryakyn products sold hereunder, shall be free of defects in materials and workmanship for a period of one (1) year from the date of purchase by the consumer excepting the following provisions:

- Kuryakyn shall have no obligation in the event the customer is unable to provide a receipt showing the date the customer purchased the product(s).
- The product must be properly installed, maintained and operated under normal conditions.
- Kuryakyn makes no warranty, expressed or implied, with respect to any gold plated products.
- Kuryakyn shall not be liable for any consequential and incidental damages, including labor and paint, resulting from failure of a Kuryakyn product, failure to deliver, delay in delivery, delivery in nonconforming condition, or for any breach of contract or duty between Kuryakyn and a customer.
- Kuryakyn products are often intended for use in specific applications. Kuryakyn makes no warranty if a Kuryakyn product is used in applications other than intended.
- Kuryakyn electrical products are warranted for one (1) year from the date of purchase by the consumer. Components of Kuryakyn products containing L.E.D.s will be warranted for defects in materials and workmanship for 3 years from the date of purchase.
- Kuryakyn makes no warranty of any kind in regard to other manufacturer's products distributed by Kuryakyn. Kuryakyn will pass on all warranties made by the manufacturer and where possible, will expedite the claim on behalf of the customer, but ultimately, responsibility for disposition of the warranty claim lies with the manufacturer.

ABOUT OUR CATALOG

You'll find all our innovations for H-D, GL and Metric Cruisers in our annual catalogs. Order online today—select the "CATALOGS" icon. Each Kuryakyn® product comes with a Proof-of-Purchase good for a complimentary catalog. Details in packaging.

Be sure to ask your local dealer about other Kuryakyn® products, the motorcycle parts and accessories designed for riders by riders.

©2005 Kuryakyn USA® All Rights reserved.



STEP 2 Carefully remove the fairing-molding pieces from both sides of the motorcycle as shown in PIC. 1 starting at the bottom of the molding; pulling out to disengage the tabs, working your way up the piece.

STEP 3 Remove the three screws underneath the trim piece on the right side of the motorcycle as shown in PIC. 2.

STEP 4 Install two short and one long mounting brackets from the bottom side of the right Dragon Wing as shown in PIC. 3. Secure with the 1/4-20 x 5/8" PHS screws and 1/4-20 locking nuts from the hardware kit. Only snug the screws and nuts at this point, do not tighten them.

STEP 5 Hold the right Dragon Wing in place so that the holes in the mounting tabs line up with the holes for the screws that were removed in STEP 3; reinstall the screws, so that they just make contact with the mounting tabs. (Refer to PIC. 2 for the location of the different length screws)

STEP 6 Remove the screw from the bottom side of the right mirror as shown in PIC. 4, hold onto the mirror so it does not fall out.

CAUTION! Once the screw has been removed there is no longer anything holding the mirror in place. The mirror could potentially fall out and be damaged!

STEP 7 Refer to PIC. 5 to determine the right upper vent; place a M5 x .08 x 25 PHS screw and M5 flat washer from the bottom of the mounting tab and place the spacer over the protruding end of the screw as shown in PIC. 6.

STEP 8 Install the upper vent with the screw to the bottom of the mirror as shown in PIC. 7; be careful not to over tighten the screw.

NOTE: If the screw that secures the upper vent is ever removed, we recommend applying blue Loctite to the screw before reinstalling it.

STEP 9 Adjust the Dragon Wings so that the top edge of the Dragon Wing is in line with the bottom edge of the upper vent and so that the upper vent is behind the tab on the Wing as shown in PIC. 8; verify that there is clearance between the hardware for the mounting brackets and the fairing.

STEP 10 Snug the screws that secure the Dragon Wing to the motorcycle.

STEP 11 Check the angle between the upper vent and Dragon Wing, they should be parallel as shown in PIC. 7; if they are not parallel, rotate the upper vent out of the way, press on the mounting bracket and slightly (see PIC. 9) lift up on the Dragon Wing to bend the bracket and make them parallel.

STEP 12 Once the location of the Dragon Wing has been established, tighten all of the fasteners; re-check for adequate clearance between the hardware and the fairing.

STEP 13 Carefully reinstall the fairing trim starting at the top, inserting the front tab and working your way down the molding, being careful not to break the tabs.

STEP 14 Repeat STEP 3 through STEP 13 for the left side.

-cont.-

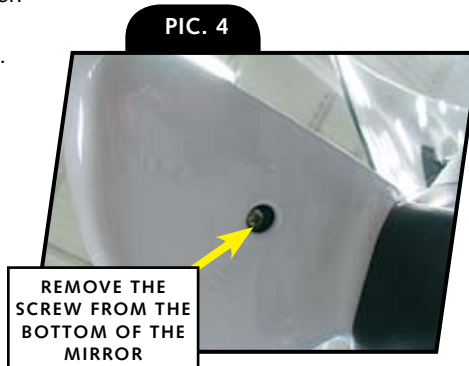
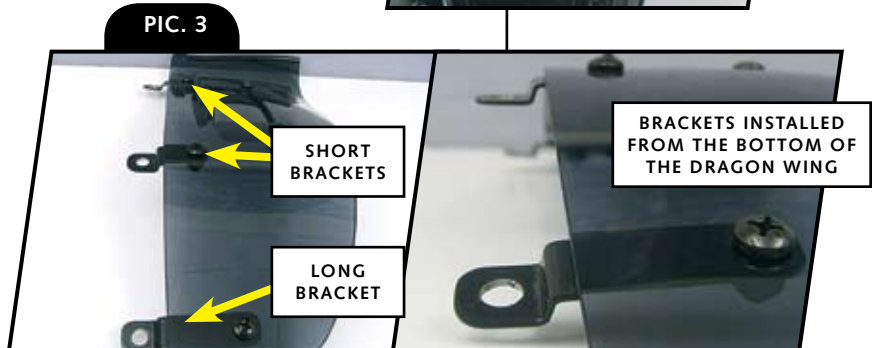

ATTENTION! It is the installer's responsibility to ensure that all of the fasteners (including pre-assembled) are tightened before operation of the motorcycle. Kuryakyn will not warranty components lost due to improper installation. Periodic maintenance may be required.

TENSION ADJUSTMENT

STEP 1 The screws that secure the upper vent to the mirrors can be tightened to achieve more tension for the adjustment of the upper vents and should be checked routinely.

STEP 2 The hardware that secures the vent in the Dragon Wing can be tightened or loosened to put more/less tension on the vent. Both the upper and lower screws should be tightened so that they apply the same amount of tension so that the vent moves freely. This hardware should also be routinely checked.

CAUTION! It is the installer's responsibility to ensure that there is adequate clearance between the Dragon Wing and any painted surfaces. Kuryakyn is not responsible for any damage due to inadequate clearance.

CAUTION! Clean only with warm water and a mild, non-abrasive soap. Some cleaning products contain harsh chemicals that can severely damage product and void warranty.

WARNING! DO NOT CLEAN POLYCARBONATE IN HOT SUN OR HIGH TEMPERATURE. POWDERED, ABRASIVE OR ALKALINE CLEANSER WILL DAMAGE THE WINDSHIELD. NEVER SCRAPE THE WINDSHIELD WITH A RAZOR BLADE OR OTHER SHARP INSTRUMENT.

WARNING! DO NOT USE BENZENE, PAINT THINNER, GASOLINE OR ANY OTHER TYPE OF HARSH CLEANER ON THE WINDSHIELD. DO NOT USE AMMONIA BASED SOLVENTS OR PETROLEUM DISTILLATES. DOING SO WILL DAMAGE THE WINDSHIELD SURFACE.

WARNING! DO NOT USE HARSH CHEMICALS INCLUDING RAIN SHEETING PRODUCTS ON MOTORCYCLE WINDSHIELDS. THEY CAN CAUSE A DULLING OR HAZING. TO OBTAIN A PROPER HIGH-END POLISH, PLEASE USE A QUALITY PROTECTOR AND POLISH SUCH AS PLEXUS OR NOVUS BRAND CLEANERS. DO NOT USE RAIN-X OR OTHER AMMONIA BASED CLEANING OR PROTECTION PRODUCT ON THIS PRODUCT.

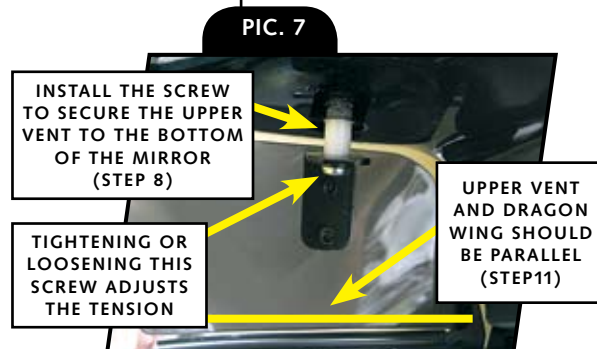
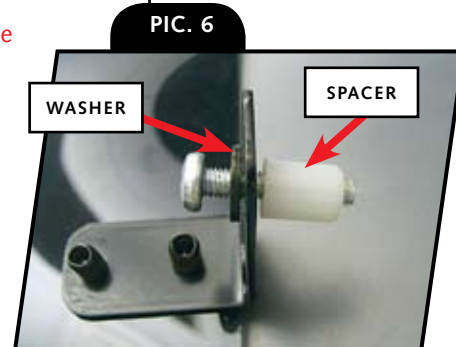

Ride On!

