



MINI ERGO ARMS 4071

FOR ERGO II CRUISE MOUNTS

FITS: ALL KÜRYAKYN ERGO & ERGO II CRUISE PEGS FOR GL 1500 & 1800

PARTS INCLUDED

- 2 Mini Ergo Arms
- 2 1/2-13 X 3/4" Socket Head Cap Screws (SHCS)
- 1 Installation Instructions

Please read and understand entire instructions before starting installation.

THANK YOU FOR CHOOSING KÜRYAKYN!

IN ORDER TO PROTECT YOU AND OTHERS FROM POSSIBLE INJURY AND/OR PROPERTY DAMAGE OR LOSS, PLEASE PAY CLOSE ATTENTION TO ALL INSTRUCTIONS, WARNINGS, CAUTIONS AND ATTENTION NOTES REGARDING THE USE AND CARE OF THIS PRODUCT.

WARNING! THIS INDICATION ALERTS YOU TO THE FACT THAT IGNORING THE CONTENTS DESCRIBED HEREIN CAN RESULT IN POTENTIAL DEATH OR SERIOUS INJURY.

ATTENTION! This indication alerts you to the fact that ignoring the contents described herein may negatively affect product performance and functionality.

TOOLS SUGGESTED

Set of hex wrenches.

STRICTLY OBSERVE THE FOLLOWING GUIDELINES IN ORDER TO USE THE PRODUCT PROPERLY AND AVOID POTENTIALLY DANGEROUS ACCIDENTS.

PROCEDURE

STEP 1 Read and understand all steps in the instructions before starting the installation. Park the motorcycle on a hard, level surface and turn off the ignition.

STEP 2 Remove the screw that secures the clevis and peg assembly to the arm, this screw will not be used again. (PIC. 1)

STEP 3 Remove the screw that secures the arm to the cruise mount and set aside to reinstall. (PIC. 1)

STEP 4 Once you have the clevis off, place the clevis on the mini ergo arm and start one of the included screws. (PIC. 2)

STEP 5 Place the mini ergo arm on the cruise mount and secure with the screw that was removed in STEP 3. (PIC. 2)

-cont.-

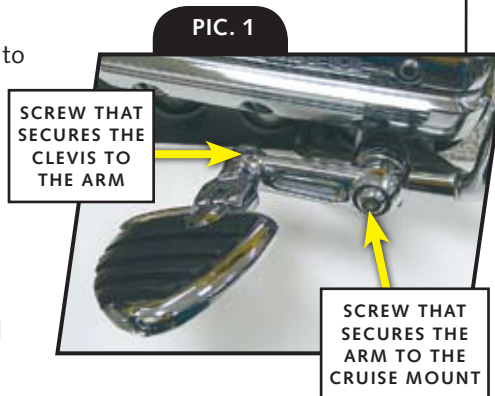

CUSTOMER SERVICE

877.370.3604 (toll free)

INSTALLATION QUESTIONS

techsupport@kuryakyn.com
or call 715.247.2983

LIMITED WARRANTY

Küryakyn warrants that any Küryakyn products sold hereunder, shall be free of defects in materials and workmanship for a period of one (1) year from the date of purchase by the consumer excepting the following provisions:

- Küryakyn shall have no obligation in the event the customer is unable to provide a receipt showing the date the customer purchased the product(s).
- The product must be properly installed, maintained and operated under normal conditions.
- Küryakyn makes no warranty, expressed or implied, with respect to any gold plated products.
- Küryakyn shall not be liable for any consequential and incidental damages, including labor and paint, resulting from failure of a Küryakyn product, failure to deliver, delay in delivery, delivery in non-conforming condition, or for any breach of contract or duty between Küryakyn and a customer.
- Küryakyn products are often intended for use in specific applications. Küryakyn makes no warranty if a Küryakyn product is used in applications other than intended.
- Küryakyn electrical products are warranted for one (1) year from the date of purchase by the consumer. Components of Küryakyn products containing L.E.D.s will be warranted for defects in materials and workmanship for 3 years from the date of purchase.
- Küryakyn makes no warranty of any kind in regard to other manufacturer's products distributed by Küryakyn. Küryakyn will pass on all warranties made by the manufacturer and where possible, will expedite the claim on behalf of the customer, but ultimately, responsibility for disposition of the warranty claim lies with the manufacturer.

ABOUT OUR CATALOG

You'll find all our innovations for H-D, GL and Metric Cruisers in our annual catalogs. Order online today—select the "CATALOGS" icon. Each Küryakyn® product comes with a Proof-of-Purchase good for a complimentary catalog. Details in packaging.

Be sure to ask your local dealer about other Küryakyn® products, the motorcycle parts and accessories designed for riders by riders.

©2005 Küryakyn USA® All Rights reserved.



NOTE: The mini ergo arm needs to be placed so that the offset goes up.

STEP 6 Repeat STEP 2 through STEP 5 for the other side.

STEP 7 With the mini ergo arms on the bike, sit on the bike and adjust the clevis/peg assembly to the desired position.

STEP 8 Once the position of the peg has been determined, tighten the screws that secure the clevis to mini ergo arms.

WARNING! IMPROPER INSTALLATION OR USE OF THIS PRODUCT COULD RESULT IN SERIOUS INJURY OR DEATH.

STEP 9 Tighten all of the hardware.

WARNING! FAILURE TO PROPERLY ADJUST THE MINI ERGO ARMS COULD RESULT IN LOSS OF CONTROL CAUSING SEVERE INJURY OR DEATH.

WARNING! THE ADDITION OF THE MINI ERGO ARMS MAY AFFECT CORNERING CLEARANCE IN SOME SITUATIONS.

ATTENTION! It is the installer's responsibility to ensure that all of the fasteners (including pre-assembled) are tightened before operation of the motorcycle. Kuryakyn will not warranty components lost due to improper installation. Periodic maintenance may be required.

Ride On!

Kuryakyn[®]

PIC. 2

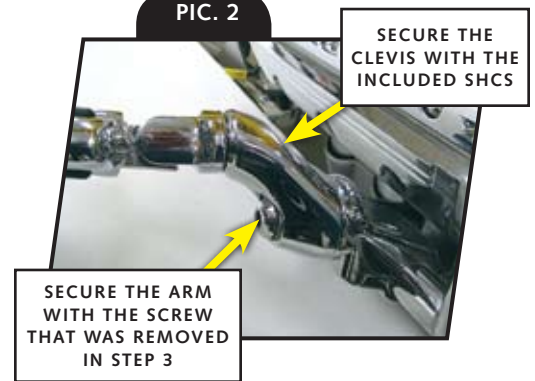

PAGE

2