



**LONG RIGHT ANGLE MOUNT 4509**

**WITH 1" MAGNUM QUICK CLAMPS AND DUALY ISO-PEGS**

**FITS: ALL MODELS EQUIPPED WITH 1" ENGINE GUARDS OR FRONT FRAME DOWN TUBES**

**PARTS INCLUDED**

- 2 Dually ISO Pegs
- 2 Long Right Angle Mounts
- 2 1" Magnum Quick Clamps
- 2 Peg Mount Clevis
- 1 Installation Instructions

*Please read and understand entire instructions before starting installation.*

**THANK YOU FOR CHOOSING KÜRYAKYN!**

**IN ORDER TO PROTECT YOU AND OTHERS FROM POSSIBLE INJURY AND/OR PROPERTY DAMAGE OR LOSS, PLEASE PAY CLOSE ATTENTION TO ALL INSTRUCTIONS, WARNINGS, CAUTIONS AND ATTENTION NOTES REGARDING THE USE AND CARE OF THIS PRODUCT.**

**WARNING!** THIS INDICATION ALERTS YOU TO THE FACT THAT IGNORING THE CONTENTS DESCRIBED HEREIN CAN RESULT IN POTENTIAL DEATH OR SERIOUS INJURY.

**CAUTION!** This indication alerts you to the fact that ignoring the contents described herein can result in potential injury or material damage.

**ATTENTION!** This indication alerts you to the fact that ignoring the contents described herein may negatively affect product performance and functionality.

**TOOLS SUGGESTED**

Set of hex wrenches, combination wrenches or socket set and ratchet.

**STRICTLY OBSERVE THE FOLLOWING GUIDELINES IN ORDER TO USE THE PRODUCT PROPERLY AND AVOID POTENTIALLY DANGEROUS ACCIDENTS.**

**PROCEDURE**

**STEP 1** Read and understand all steps in the instructions before starting the installation. Park the motorcycle on a hard, level surface and turn off the ignition.

**STEP 2** Referring to FIG.1, (see page 2) remove the 1/2" bolt, spacer, lock washer, and lock plate from the right angle mount. Set these items aside for now, they will be used to install the mount.

**ATTENTION!** Determine the mounting location and orientation of the Magnum Clamp before fully tightening the fasteners. The clamp may leave marks when tightened down.

**-cont.-**

**CUSTOMER SERVICE**

877.370.3604 (toll free)

**INSTALLATION QUESTIONS**

techsupport@kuryakyn.com  
or call 715.247.2983

**LIMITED WARRANTY**

Kuryakyn warrants that any Kuryakyn products sold hereunder, shall be free of defects in materials and workmanship for a period of one (1) year from the date of purchase by the consumer excepting the following provisions:

- Kuryakyn shall have no obligation in the event the customer is unable to provide a receipt showing the date the customer purchased the product(s).
- The product must be properly installed, maintained and operated under normal conditions.
- Kuryakyn makes no warranty, expressed or implied, with respect to any gold plated products.
- Kuryakyn shall not be liable for any consequential and incidental damages, including labor and paint, resulting from failure of a Kuryakyn product, failure to deliver, delay in delivery, delivery in nonconforming condition, or for any breach of contract or duty between Kuryakyn and a customer.
- Kuryakyn products are often intended for use in specific applications. Kuryakyn makes no warranty if a Kuryakyn product is used in applications other than intended.
- Kuryakyn electrical products are warranted for one (1) year from the date of purchase by the consumer. Components of Kuryakyn products containing L.E.D.s will be warranted for defects in materials and workmanship for 3 years from the date of purchase.
- Kuryakyn makes no warranty of any kind in regard to other manufacturer's products distributed by Kuryakyn. Kuryakyn will pass on all warranties made by the manufacturer and where possible, will expedite the claim on behalf of the customer, but ultimately, responsibility for disposition of the warranty claim lies with the manufacturer.

**ABOUT OUR CATALOG**

You'll find all our innovations for H-D, GL and Metric Cruisers in our annual catalogs. Order online today—select the "CATALOGS" icon. Each Kuryakyn product comes with a Proof-of-Purchase good for a complimentary catalog. Details in packaging.

Be sure to ask your local dealer about other Kuryakyn products, the motorcycle parts and accessories designed for riders by riders.

©2005 Kuryakyn USA All Rights reserved.



**STEP 3** Place the Magnum Quick Clamp around the tube that you choose as your mounting point. Close the clamp; insert the bolt that was removed in STEP 1, being sure to use the lock washer, and place the spacer in between the clamp halves. (Refer to FIG.1.)

**NOTE** Spacer washer must be installed between clamp halves! Failure to do so may result in unsecured clamping or damage to the clamp.

**STEP 4** Place the lock plate on the other side of the clamp so that the smooth side is facing the clamp and the splines are facing outwards.

**STEP 5** Place the right angle mount on the clamp and secure with the bolt. Do not fully tighten them at this point. Sit on the bike and determine the desired arm orientation, adjust as needed and tighten the bolt.

**STEP 6** The angle of the peg may be adjusted by loosening the screw in the right angle mount that secures the clevis or the screw that secures the peg to the peg adapter (refer to PIC.1.) Rotate to the desired position and re-tighten the bolts.

**STEP 7** Rotate the clevis to the desired position and securely tighten the assembly.

**STEP 8** Repeat STEP 2 through STEP 7 for the opposite side.

**WARNING!** CHECK TO MAKE SURE THAT THERE IS PROPER CLEARANCE WHEN CORNERING. LOSS OF CONTROL OF THE MOTORCYCLE AND SERIOUS INJURY MAY OCCUR IF THE PEG/ARM IS NOT POSITIONED PROPERLY. REPOSITION THE RIGHT ANGLE MOUNT IF NECESSARY SO THAT THERE IS ADEQUATE CORNERING CLEARANCE.

**STEP 9** Tighten all fasteners.

**ATTENTION!** It is the installer's responsibility to ensure that all of the fasteners (including pre-assembled) are tightened before operation of the motorcycle. Kuryakyn will not warranty components lost due to improper installation. Periodic maintenance may be required.

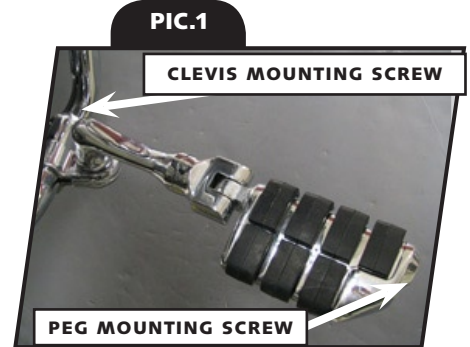
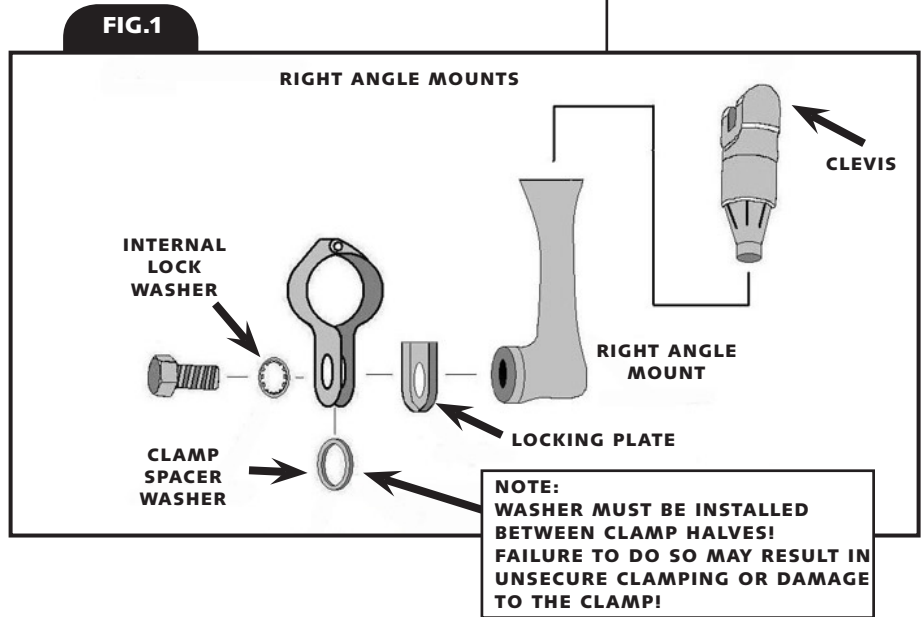

*Ride On!*