



BEAST OVAL MUFFLERS

479

PARTS INCLUDED

- 1 Left Side Beast Oval Muffler with Mad Stax Tip
- 1 Right Side Beast Oval Muffler with Mad Stax Tip
- 2 Band Clamps
- 4 5/16"-18 X 5/8" Flange Hex Head Screws
- 2 Nut Plates
- 2 Mounting Brackets
- 1 Installation Instructions

Please read and understand entire instructions before starting installation.

THANK YOU FOR CHOOSING KÜRYAKYN!

IN ORDER TO PROTECT YOU AND OTHERS FROM POSSIBLE INJURY AND/OR PROPERTY DAMAGE OR LOSS, PLEASE PAY CLOSE ATTENTION TO ALL INSTRUCTIONS, WARNINGS, CAUTIONS AND ATTENTION NOTES REGARDING THE USE AND CARE OF THIS PRODUCT.

WARNING! THIS INDICATION ALERTS YOU TO THE FACT THAT IGNORING THE CONTENTS DESCRIBED HEREIN CAN RESULT IN POTENTIAL DEATH OR SERIOUS INJURY

CAUTION! This indication alerts you to the fact that ignoring the contents described herein can result in potential injury or material damage.

ATTENTION! This indication alerts you to the fact that ignoring the contents described herein may negatively affect product performance and functionality.

TOOLS SUGGESTED

Screwdrivers, Socket Set with Ratchet, Combination Wrenches

STRICTLY OBSERVE THE FOLLOWING GUIDELINES IN ORDER TO USE THE PRODUCT PROPERLY AND AVOID POTENTIALLY DANGEROUS ACCIDENTS.

STEP 1 Read and understand all steps in the instructions before starting the installation. Park the motorcycle on a hard, level surface and turn off the ignition. Let cool.

WARNING! YOU WILL BE WORKING AROUND THE ENGINE AND EXHAUST SYSTEM DURING INSTALLATION. ENSURE THAT THE ENGINE AND EXHAUST SYSTEM HAVE FULLY COOLED TO PREVENT INJURY.

CAUTION! The installation of any high performance exhaust system can cause a "lean" fuel/air mixture. A "lean" fuel/air mixture can cause engine overheating resulting in severe engine damage. Kuryakyn recommends having carbureted bikes rejetted and fuel injected bikes tuned with a TTS MasterTune tuning system (calibrations available at www.kuryakyn.com), or by an experienced tuner, on a dyno, with an exhaust gas analyzer.

CUSTOMER SERVICE

877.370.3604 (toll free)

INSTALLATION QUESTIONS

techsupport@kuryakyn.com
or call 715.247.2983

LIMITED WARRANTY

Kuryakyn warrants that any Kuryakyn products sold hereunder, shall be free of defects in materials and workmanship for a period of one (1) year from the date of purchase by the consumer excepting the following provisions:

- Kuryakyn shall have no obligation in the event the customer is unable to provide a receipt showing the date the customer purchased the product(s).
 - The product must be properly installed, maintained and operated under normal conditions.
 - Kuryakyn makes no warranty, expressed or implied, with respect to any gold plated products.
 - Kuryakyn shall not be liable for any consequential and incidental damages, including labor and paint, resulting from failure of a Kuryakyn product, failure to deliver, delay in delivery, delivery in nonconforming condition, or for any breach of contract or duty between Kuryakyn and a customer.
- Kuryakyn products are often intended for use in specific applications. Kuryakyn makes no warranty if a Kuryakyn product is used in applications other than intended.
- Kuryakyn electrical products are warranted for one (1) year from the date of purchase by the consumer. L.E.D.'S contained in components of Kuryakyn products will be warranted for defects in materials and workmanship for 3 years from the date of purchase where as all other components shall be warranted for one(1) year. This includes, but is not limited to; control modules, wiring, chrome & other components.
- Kuryakyn makes no warranty of any kind in regard to other manufacturer's products distributed by Kuryakyn. Kuryakyn will pass on all warranties made by the manufacturer and where possible, will expedite the claim on behalf of the customer, but ultimately, responsibility for disposition of the warranty claim lies with the manufacturer.

ABOUT OUR CATALOG

For purchasing Kuryakyn® products, you can receive a complete catalog free of charge. Send the Proof-of-Purchase below with your address to: Kuryakyn, P.O. Box 339, Somerset, WI 54025. Please indicate either Accessories Catalog for Harley-Davidson® or GL & Metric Cruisers.

Be sure to ask your local dealer about other Kuryakyn® products, the motorcycle parts and accessories designed for riders.

©2005 Kuryakyn USA® All Rights reserved.



CAUTION! KURYAKYN DOES NOT WARRANTY ANY CHROME EXHAUST PRODUCTS AGAINST DISCOLORATION! Discoloration is not a defect in chrome. All chrome exhaust systems will turn color. Chrome discoloration is a result of heat. The more heat the chrome is exposed to, the quicker and more severe the discoloration will be.

Procedure

STEP 2 Remove both saddlebags and set them aside.

STEP 3 Loosen the bolt from the pinch clamp on the front end of each muffler.

STEP 4 Working with one muffler at a time, support the muffler (assistance may be required) while removing the 5/16" bolts from the saddlebag support and slide muffler off of the head pipe.

STEP 5 Repeat the process for the opposite muffler.

NOTE: A few drops of a penetrating oil applied near head pipe/muffler union will aid in removal.

STEP 6 Leaving the grommets in place, remove the stock mounting brackets from the rubber grommets located on the saddlebag supports (PIC1).

NOTE: Inspect the grommets to verify that they are in good condition, if the grommets are damaged they will need to be replaced.

STEP 7 Install the muffler brackets (supplied) into the grommets on the saddlebag supports so that the tongue faces upwards (PIC 2).

NOTE: Use of penetrating lubricant may help to slide the bracket into the grommet.

STEP 8 Install the band clamps (supplied) over the front of each muffler so that the bolt is to the inside and the nut is facing down (PIC 3).

NOTE: New band clamps are supplied, do not use the old clamps.

STEP 9 Slide nut plates inside the brackets welded to backside of muffler bodies (PIC 4). While holding nut plates, slide muffler over stock exhaust head pipe and carefully attach muffler bodies to the mounting bracket using the supplied 5/16"-18 x 5/8" flange head bolts (leave them loose at this time)

NOTE: Muffler heat shield is placed under head pipe heat shield. Take care not to allow the headpipe heat shield to rub the front of the muffler heat shield.

STEP 10 Repeat installation procedure for opposite muffler.

STEP 11 Align mufflers and tighten hardware, beginning with the 5/16"-18 x 5/8" flange bolts on the mounting brackets followed by the band clamp.

NOTE: You may want to use an assistant at this time to visually check alignment while you tighten the hardware. Pay special attention to making sure the muffler does not droop, when viewed from the back of the motorcycle. Torque spec. is 40-45 Ft./Lbs.

STEP 12 Tighten all heat shield clamps.

STEP 13 Replace the saddlebags.

-cont.-

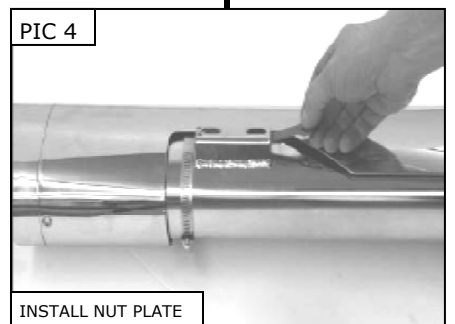
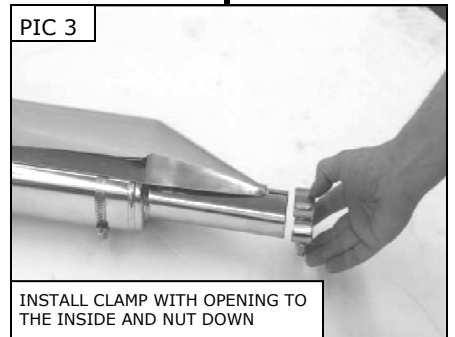
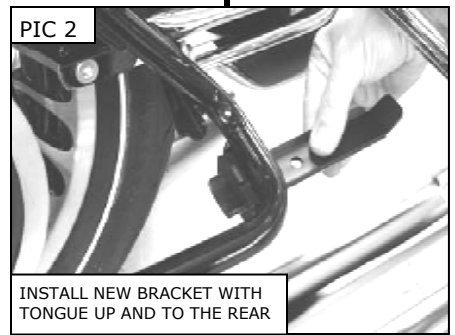
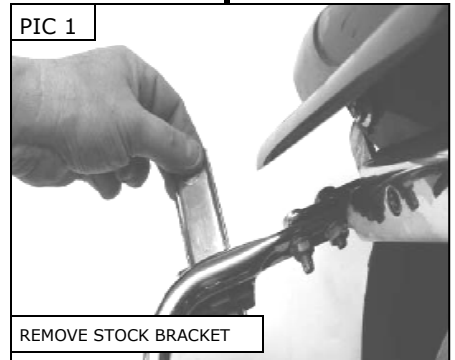

STEP 14 After installation and before starting motorcycle, completely clean pipes and mufflers with cleaning solvent and a clean, soft cloth that will not leave a residue.

NOTE: Any residue, oil, or fingerprints will stain the chrome when the metal heats up.

STEP 15 Be sure to tighten all hardware before starting your motorcycle.

Design Note: For a different look the End Caps may be removed and re-installed with the slash facing up.

ATTENTION! It is the installer's responsibility to ensure that all of the fasteners (including preassembled) are tightened before operation of the motorcycle. Kuryakyn will not warranty components lost due to improper installation. Periodic maintenance may be required.

CAUTION! AFTER TEST RIDE LET PIPES COOL DOWN AND RE-TORQUE MUFFLER BAND CLAMP.

CAUTION! KURYAKYN DOES NOT WARRANTY ANY CHROME EXHAUST PRODUCTS AGAINST DISCOLORATION! Discoloration is not a defect in chrome. All chrome exhaust systems will turn color. Chrome discoloration is a result of heat. The more heat the chrome is exposed to, the quicker and more severe the discoloration will be.

ATTENTION! EXHAUST CARE

1. Proper tuning is important. We recommend carbureted bikes should be rejetted and fuel injected bikes should be tuned with a TTS MasterTune tuning system (calibrations available at www.kuryakyn.com), or by an experienced tuner, on a dyno, with an exhaust gas analyzer. 2007 and up Harley Twin Cams run especially lean combined with retarded ignition timing. Lean conditions and/or retarded ignition timing will cause high exhaust temperatures and discolor chrome exhaust.
2. Avoid long periods of idling as this can cause discoloration
3. Make sure there are no exhaust leaks at the junction of the exhaust pipes and cylinder heads. We recommend replacing the gaskets with Kuryakyn Wild Things™ - Cometic exhaust gaskets, P/N 482.
4. Make sure there are no intake leaks. Intake leaks will cause a lean condition and engine overheating. This could lead to discoloration.
5. When installing new chrome exhaust, make sure your hands are clean and free of grease and oil. After installation, thoroughly clean pipes with a soft clean cloth and cleaning solvent that will leave no residue (glass cleaner, alcohol, ammonia, etc...) before starting the motorcycle.

Ride On!

PAGE

3

BEAST OVAL MUFFLER

INSTALLATION