



INSTALLATION



SKULL AIR CLEANER KIT FOR YAMAHA 9955

CUSTOMER SERVICE

877.370.3604 (toll free)

INSTALLATION QUESTIONS

techsupport@kuryakyn.com
or call 715.247.2983

LIMITED WARRANTY

Kuryakyn warrants that any Kuryakyn products sold hereunder, shall be free of defects in materials and workmanship for a period of one (1) year from the date of purchase by the consumer excepting the following provisions:

- Kuryakyn shall have no obligation in the event the customer is unable to provide a receipt showing the date the customer purchased the product(s).
- The product must be properly installed, maintained and operated under normal conditions.
- Kuryakyn makes no warranty, expressed or implied, with respect to any gold plated products.
- Kuryakyn shall not be liable for any consequential and incidental damages, including labor and paint, resulting from failure of a Kuryakyn product, failure to deliver, delay in delivery, delivery in nonconforming condition, or for any breach of contract or duty between Kuryakyn and a customer.
- Kuryakyn products are often intended for use in specific applications. Kuryakyn makes no warranty if a Kuryakyn product is used in applications other than intended.
- Kuryakyn electrical products are warranted for one (1) year from the date of purchase by the consumer. Components of Kuryakyn products containing L.E.D.s will be warranted for defects in materials and workmanship for 3 years from the date of purchase.
- Kuryakyn makes no warranty of any kind in regard to other manufacturer's products distributed by Kuryakyn. Kuryakyn will pass on all warranties made by the manufacturer and where possible, will expedite the claim on behalf of the customer, but ultimately, responsibility for disposition of the warranty claim lies with the manufacturer.

ABOUT OUR CATALOG

You'll find all our innovations for H-D, GL and Metric Cruisers in our annual catalogs. Order online today—select the "CATALOGS" icon. Each Kuryakyn™ product comes with a Proof-of-Purchase good for a complimentary catalog. Details in packaging.

Be sure to ask your local dealer about other Kuryakyn products, the motorcycle parts and accessories designed for riders by riders.

©2005 Kuryakyn USA™ All Rights reserved.



FITS: '98-'05 V-STAR 650

PART #	INCLUDED
509944	1 Skull Air Cleaner Assembly Including: 1 Skull Head Cover 1 Cage Assembly Black Powder Coated 1 Backing Plate 1 Dual Velocity Ring - Not Used
909944	1 Mounting Hardware Kit Including: 3 1/4"-20 x 1" BSCS 18-8 3 1/4"-20 x 3/4" SHCS 18-8 3 1/4" Nylon Washer
400545	1 K&N Air Filter
609944	1 Plug & Elbow Kit Including: 2 1/8" NPT Hex Threaded Plug (1 used) 2 90 Degree Barbed Elbow (1 used)
909422	1 Mounting Kit Including: 1 Rubber Manifold 1 Mounting Bracket 4 M6 Aluminum Spacer 3 1/4"-20 x 5/8" SHCS Alloy with Patch 3 1/4"-20 Nylock Nut 3 M6 Aluminum Tapered Bolt Cap 2 M6 x 1.0 mm x 30mm SHCS 1 M6 x 1.0mm x 16mm SHCS 1 6mm Serrated Flange Nut 3 M6 Flat Washer 1 18" 5/32" Vacuum Line (not used) 1 90 Degree Elbow 1 5" Hose 5/16" I.D. 1 Aluminum Pipe 3/8" x 1-1/4" Hose Splice 1 3 Way Barbed "T" Fitting (not used)
609452	1 Jet Kit Including: 2 Pilot Jet 2 117.5 Main Jet 2 120.0 Main Jet 2 122.5 Main Jet
309955	1 Installation Instructions

Not all parts will be used for this installation

THANK YOU FOR CHOOSING KURYAKYN!

DISCLAIMER – PLEASE READ BEFORE PROCEEDING:

Any modifications to a carbureted motorcycle's exhaust or intake tract require carburetor re-jetting to achieve maximum performance and maintain drivability. If you are uncomfortable with the process of tuning your carburetor, we recommend that you bring your motorcycle to a qualified motorcycle mechanic to have this kit installed.

-cont.-

DISCLAIMER (CONT.)

The jets included in this kit were selected based on test results with various combinations of components that we felt would represent the majority of the customers purchasing this kit. However, no two motorcycles are exactly alike. Depending on the individual case, additional jets may need to be purchased from an outside source. Kuryakyn warrants the parts included in this kit to be free of defects in materials and workmanship, but makes no claim whatsoever in regard to costs associated with installation or tuning.

NOTE Please read each step of the instruction before proceeding with the installation.

PROCEDURE

STEP 1 Remove the stock air cleaner and components to the point shown in PIC.1. The stock plastic air box adapter "A" and stock mounting brackets "B" will remain in place.

STEP 2 Remove the carburetor according to the section in your factory service manual that outlines procedures for carburetor removal, disassembly, reassembly and installation.

Now is a good time to proceed with re-jetting the carburetor. Consult your factory service manual for details of this procedure. We have supplied jets to cover many common configurations. Individual bikes may need additional tuning to achieve maximum performance. If your exact combination is not listed, choose the listing that most closely resembles the configuration of the motorcycle. These recommendations are based on testing done at 700 feet above sea level.

COBRA/STOCK EXHAUST

Main Jet 120

Pilot Jet 35

PMS Screw 1-1/2 Turns Out From
Bottom

V&H STYLE OR OPEN PIPES

Main Jet 122.5

Pilot Jet 35

PMS Screw 1-1/2 Turns Out From
Bottom

NOTE Your optimal performance and drivability may require some fine-tuning from these specifications. For instance, the general rule of thumb is one jet size smaller for every 3000-4000 feet of elevation.

STEP 3 Insert both flanges of the rubber adapter through the mounting bracket as shown in PIC.2. The hardware components used for installation are placed near their respective mounting points:

"A" Socket head cap screw – 30mm long, tapered bolt cap, and two spacers. The spacers are placed between the chrome and the stock mounting brackets.

"B" Socket head cap screw – 15mm long, tapered bolt cap

"C" Socket head cap screw – 30mm long, tapered bolt cap, two spacers (place between chrome and stock brackets), and flange nut.

"D" Mounting holes.

STEP 4 Install a Line Fitting Plug into the threaded hole in the back plate labeled as "A" in PIC.3 and tighten snugly.

STEP 5 Install a 90 Degree Elbow into the threaded hole on the back plate labeled as "B" in PIC.3. Tighten snugly.

-cont.-

Kuryakyn™

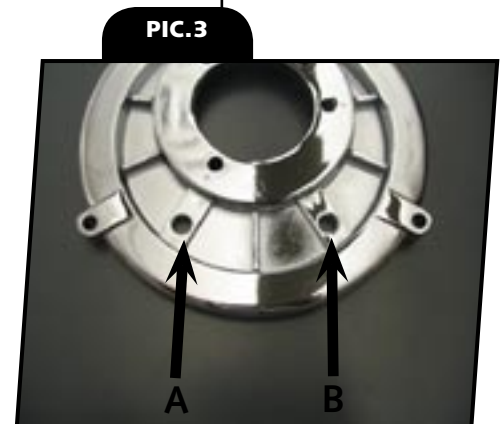
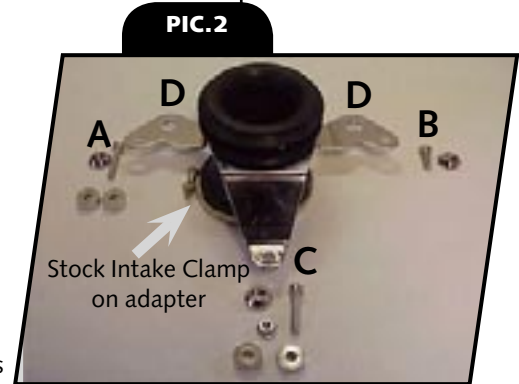
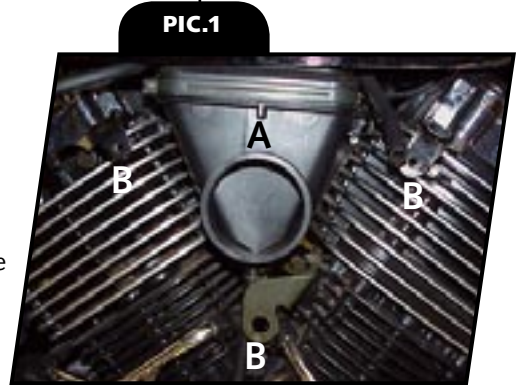

PAGE

2

SKULL AIR CLEANER KIT

INSTALLATION

STEP 6 Insert the rubber intake duct through the back plate in the same fashion it was installed in the main support bracket. See [PIC.4](#). The back plate should be between the two rubber flanges on the intake duct and the 90 Degree Elbow and Line Fitting Plug will be between the back plate and the engine on the downward end of the plate. You may need to use a screwdriver to help "poke" the flange of the Rubber Intake Boot into position inside the back plate.

STEP 7 Line up the three holes in the back plate and the three holes in the flange of the rubber intake duct with the three holes in the main support bracket. Insert the three supplied 1/4"-20 X 5/8" socket head cap screws through the back plate and secure on the back side of the main support bracket with the 1/4"-20 thin Nylock nuts. You will need to pull back the inner flange of the rubber intake duct to access the holes. Hold the Nylock nuts with a 7/16" wrench as you tighten the socket head cap screws with a 3/16" hex key. See [PIC.4](#).

STEP 8 The opening in the adapter boot must be slipped over the flange of the stock air box and secured with the stock clamp. Install the mounting bracket as shown in [PIC.5](#). Secure this assembly to the bike with the hardware shown in [PIC.2](#) and outlined in STEP 2. (The back plate was not installed for [PIC.5](#) to add clarity of assembly)

STEP 9 See [PIC.6](#). Plug the extension into the float bowl vent hose and add the 5" section of hose included. Connect this hose to the 90 degree fitting on the backside of the back plate.

STEP 10 Set the air filter into position on the back plate. Place the cage over the filter and secure with the 1/4"-20 x 1" BSCS fasteners provided.

STEP 11 Set the Skull cover in place, lining up the mounting holes with the cage. Secure with the 1/4"-20 x 3/4" SHCS fasteners and clear nylon washers. It would be a good idea to use blue lock tight (not supplied) on these fasteners. Do not over tighten.

STEP 12 Check to make sure throttle is working free before starting engine.

-cont.-

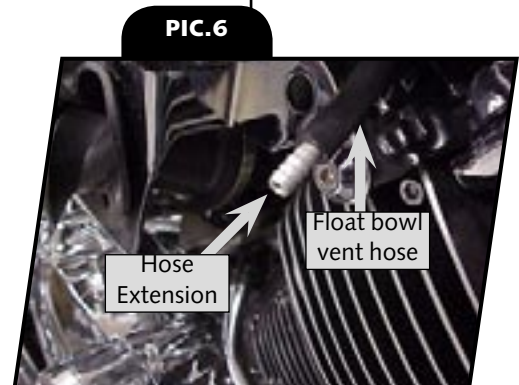
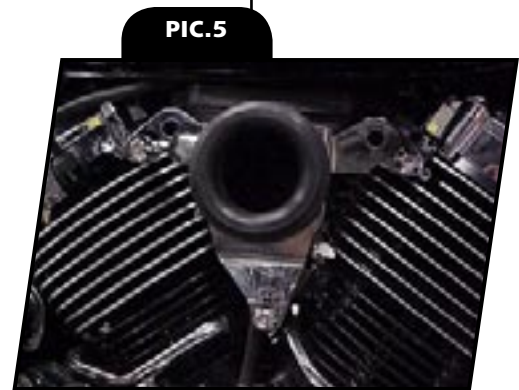
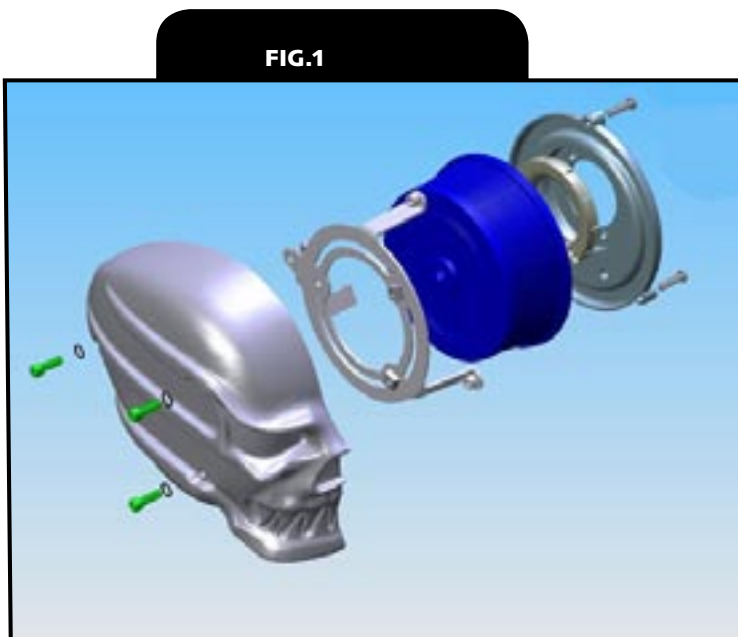
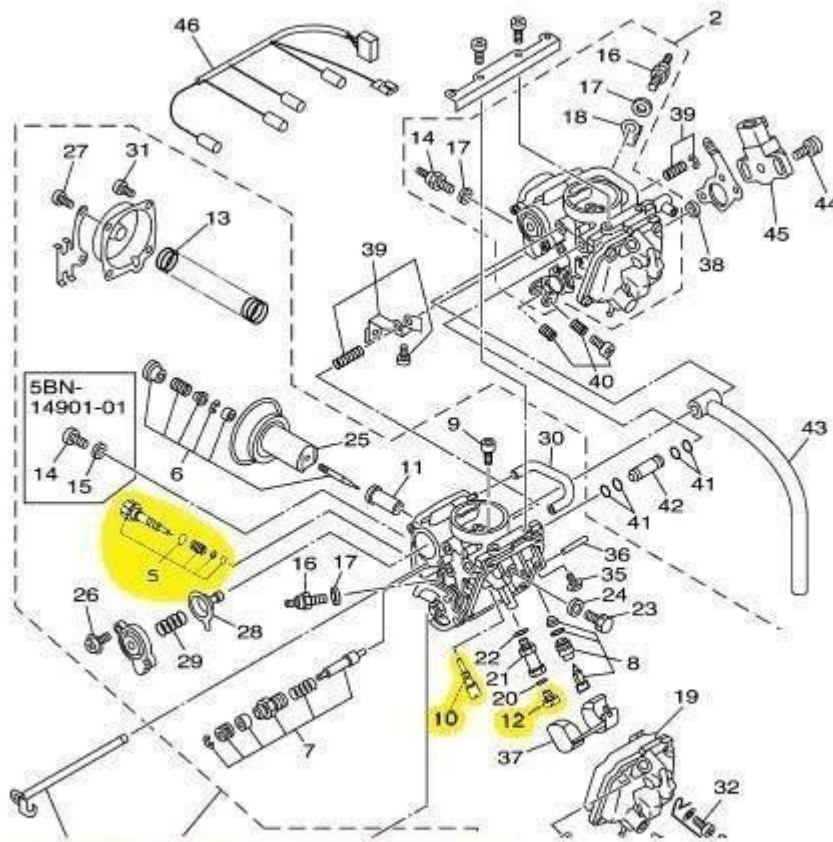

FIG.2

V-Star 650



- 5 - Pilot Screw
- 10 - Pilot Jet (20)
- 12 - Main Jet (90)

The jet sizes listed are stock and for reference use only.

ADDENDUM I

The jets included in this kit were selected based on test results with various combinations of components that we felt would represent the majority of the customers purchasing this kit. However, no two motorcycles are exactly alike. Depending on the individual case, additional jets may need to be purchased from an outside source. The following recommendations are intended as a starting point and should work well in the majority of cases. Individual bikes may need additional tuning to achieve maximum performance. If the exact combination is not listed, choose the listing that most closely resembles the configuration of the motorcycle. These baselines were established at 700 feet above sea level.

PAGE

4

Ride On!