



INSTALLATION



AMBER ACCENT FAIRING VENT LIGHTS 4628

FOR GL1800

FITS: '01-UP GL1800

PARTS INCLUDED

- 4 Amber Spider Lights
- 1 Hardware Kit including:
 - 6 Replacement Adhesive Pads
 - 2 26" Extensions
 - 2 30" Extensions
 - 2 Double Male Lizard Light Connectors
 - 2 Double Sided Replacement Tape for Intake Grills
 - 1 Dielectric Grease Packet
 - 2 Alcohol Cleaning-Pads
- 1 Installation Instructions

Please read and understand entire instructions before starting installation.

THANK YOU FOR CHOOSING KÜRYAKYN!

IN ORDER TO PROTECT YOU AND OTHERS FROM POSSIBLE INJURY AND/OR PROPERTY DAMAGE OR LOSS, PLEASE PAY CLOSE ATTENTION TO ALL INSTRUCTIONS, WARNINGS, CAUTIONS AND ATTENTION NOTES REGARDING THE USE AND CARE OF THIS PRODUCT.

CAUTION! This indication alerts you to the fact that ignoring the contents described herein can result in potential injury or material damage.

ATTENTION! This indication alerts you to the fact that ignoring the contents described herein may negatively affect product performance and functionality.

TOOLS SUGGESTED

Set of hex wrenches, electrical tape, utility knife, mineral spirits, and duct tape.

STRICTLY OBSERVE THE FOLLOWING GUIDELINES IN ORDER TO USE THE PRODUCT PROPERLY AND AVOID POTENTIALLY DANGEROUS ACCIDENTS.

PROCEDURE

STEP 1 Read and understand all steps in the instructions before starting the installation. Park the motorcycle on a hard, level surface and turn off the ignition.

ATTENTION! A factory service manual may be helpful in performing this installation. Do not attempt to perform this installation if you are not confident in your ability to complete all of the steps in the procedure; consult a trained technician.

ATTENTION! Secure all wiring away from any moving parts, pinch points or extreme heat. Kuryakyn WILL NOT warranty any electrical component that fails due to pinched, crimped, broken, abraded, melted or frayed wires.

-cont.-

CUSTOMER SERVICE

877.370.3604 (toll free)

INSTALLATION QUESTIONS

techsupport@kuryakyn.com
or call 715.247.2983

LIMITED WARRANTY

Kuryakyn warrants that any Kuryakyn products sold hereunder, shall be free of defects in materials and workmanship for a period of one (1) year from the date of purchase by the consumer excepting the following provisions:

- Kuryakyn shall have no obligation in the event the customer is unable to provide a receipt showing the date the customer purchased the product(s).
- The product must be properly installed, maintained and operated under normal conditions.
- Kuryakyn makes no warranty, expressed or implied, with respect to any gold plated products.
- Kuryakyn shall not be liable for any consequential and incidental damages, including labor and paint, resulting from failure of a Kuryakyn product, failure to deliver, delay in delivery, delivery in non-conforming condition, or for any breach of contract or duty between Kuryakyn and a customer.
- Kuryakyn products are often intended for use in specific applications. Kuryakyn makes no warranty if a Kuryakyn product is used in applications other than intended.
- Kuryakyn electrical products are warranted for one (1) year from the date of purchase by the consumer. Components of Kuryakyn products containing L.E.D.s will be warranted for defects in materials and workmanship for 3 years from the date of purchase.
- Kuryakyn makes no warranty of any kind in regard to other manufacturer's products distributed by Kuryakyn. Kuryakyn will pass on all warranties made by the manufacturer and where possible, will expedite the claim on behalf of the customer, but ultimately, responsibility for disposition of the warranty claim lies with the manufacturer.

ABOUT OUR CATALOG

You'll find all our innovations for H-D, GL and Metric Cruisers in our annual catalogs. Order online today—select the "CATALOGS" icon. Each Kuryakyn product comes with a Proof-of-Purchase good for a complimentary catalog. Details in packaging.

Be sure to ask your local dealer about other Kuryakyn products, the motorcycle parts and accessories designed for riders by riders.

©2005 Kuryakyn USA All Rights reserved.



kuryakyn.com

SUGGESTION: Referring to PIC. 1, lay out the extension wires, connectors, and spider lights on a work surface to mock up the layout.

STEP 2 For motorcycles that have intake vent inserts, carefully remove them, setting them aside to be reinstalled later using the included double-sided tape from the hardware kit.

STEP 3 Pull the rubber boot back from the fairing at the base of the mirrors.

STEP 4 Referring to PIC. 2, remove the bolts, washers and mounts that secure the windscreen garnish and set them aside to be reinstalled later.

STEP 5 Carefully pull up on the windshield garnish at the points where the bosses are located as shown in PIC. 2 to remove from the motorcycle.

STEP 6 Remove the fairing garnish by removing the three screws shown in PIC. 3, set the garnish and screws aside for now.

ATTENTION! Kuryakyn recommends the use of dielectric grease on electrical connections.

STEP 7 Locate the wiring harnesses by the base of the mirror as shown in PIC. 4; disconnect the connectors and install a Y-adapter from the hardware kit on the clutch and brake sides.

NOTE: '06-up Models require the installation of Kuryakyn P/N 7300 (not included) in order to be able to plug the Y-adapter in (see PIC. 5).

STEP 8 Plug a 26" extension into either of the pigtails on the clutch and brake side Y-adapters.

STEP 9 Plug a double male connector into the other end of the 26" extensions as shown in PIC. 6 so that the red wire in the double male connector matches up to the red wire in the extension.

STEP 10 Clean the inside of the windscreen garnish above the intake with an included alcohol cleaning pad as shown in PIC. 7 and allow the area to thoroughly dry.

ATTENTION! Ensure the area of installation is free of grease, oil, dirt or other debris to ensure proper adhesion. Kuryakyn WILL NOT warranty any parts lost due to improper installation.

ATTENTION! The adhesive will not bond correctly if applied at temperatures less than 50° F. Do not attempt this installation in temperatures less than 50° F.

STEP 11 Using the back of your fingernail, rub the backing of the adhesive pads to activate the catalyst, and then remove the backing.

-cont.-

Kuryakyn[®]

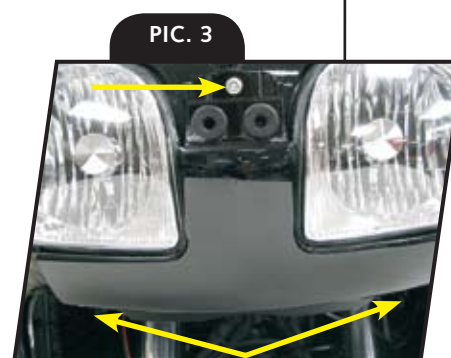
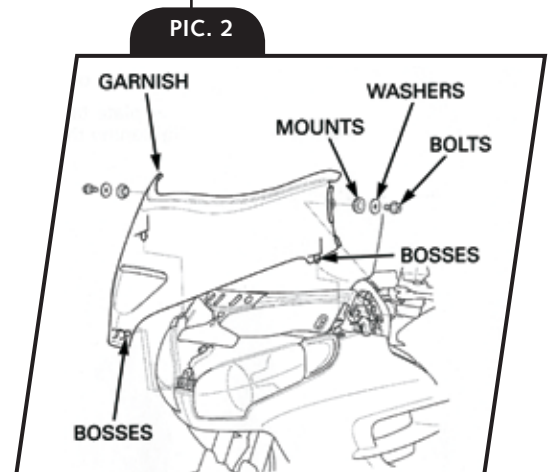
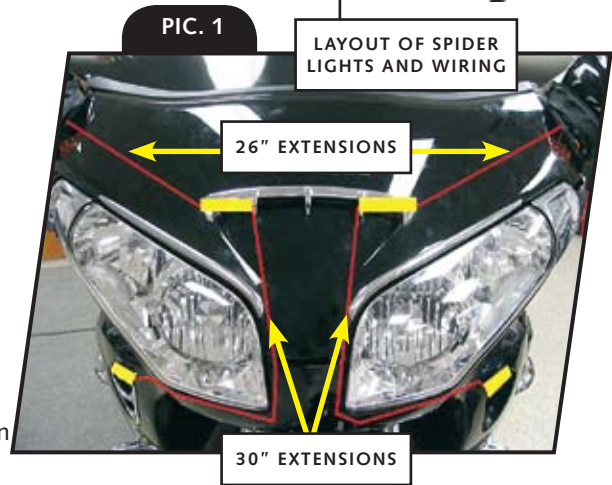

PAGE
2

STEP 12 Ensuring that the lights are placed so that the light on the clutch side will connect to the extension from the clutch side and the light on the brake side will connect to the extension with the red wires matching up; press the spider lights into place and hold for one (1) minute. Full bonding strength will occur in 24 hours. (PIC. 7)

STEP 13 Remove the two trim clips and the screw that secures the leading edge of each of the inner fairings as shown in PIC. 8, these clips and screws will be used again.

STEP 14 Lightly pull out on the brake side inner fairing.

STEP 15 Verify that the 30" extension will properly connect to the light on the windscreen garnish (red-to-red, black to black,) and route the extensions between the headlights towards the inner fairing. Make sure that there is enough slack in the wires to connect them to the lights on the windscreen garnish. (PIC. 9)

STEP 16 Insert the extensions in the inner fairing and route towards the brake side intake as shown in PIC. 9.

STEP 17 Insert the end of the wire between the two pieces of plastic and into the fairing pocket as shown in PIC. 10.

STEP 18 Clean the area inside the pocket shown in PIC. 11 with an included alcohol-cleaning pad and allow to thoroughly dry.

STEP 19 Connect the extension to the spider light, ensuring that the wires line up (red to red and black to black.)

STEP 20 Using the back of your fingernail, rub the backing of the adhesive pad to activate the catalyist, and then remove the backing.

STEP 21 Place the light in the intake making sure that it is far enough back so that there will be sufficient clearance for the vent insert. Press into place and hold for one (1) minute. Full bonding strength will occur in 24 hours.

STEP 22 Repeat STEP 14 through STEP 21 for the right side

NOTE: You may choose to secure the wires out of the way with cable ties and or duct tape.

STEP 23 Reinstall the fairing garnish and screws that were removed in STEP 6.

STEP 24 Connect the extensions to the spider lights (clutch side extension to clutch side light and brake side extension to brake side light) that are mounted on the windscreen garnish and place the windscreen in place.

STEP 25 Test to make sure the lights are operating properly (they function as running lights and turn signals).

STEP 26 Gently push the windscreen garnish into place to seat the bosses.

STEP 27 Reinstall the bolts, washers and mounts that were removed in STEP 4 (PIC. 2) to secure the windshield garnish.

PIC. 5

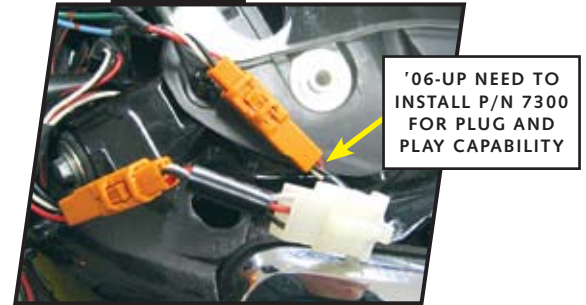

PIC. 6

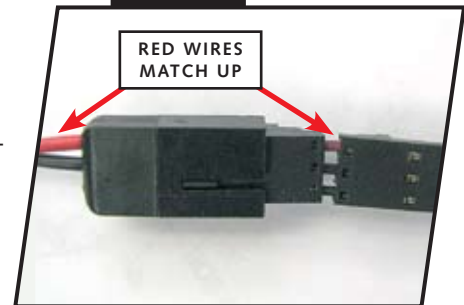

PIC. 7

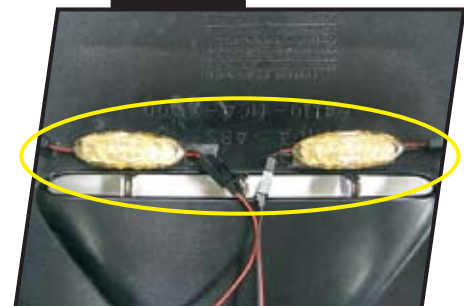

PIC. 8

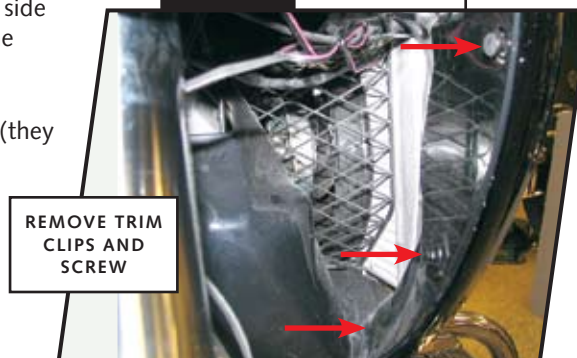

-cont.-

STEP 28 Place the rubber mirror boots in place.

STEP 29 Reinstall the inner fairings using the trim clips and screws that were removed in STEP 13 making sure the wires will not be pinched. (PIC. 8)

ATTENTION! It is the installer's responsibility to ensure that all of the fasteners (including pre-assembled) are tightened before operation of the motorcycle. Kuryakyn will not warranty components lost due to improper installation. Periodic maintenance may be required.

STEPS TO RE-INSTALL THE INTAKE VENT INSERTS

STEP 30 Remove as much of the adhesive by hand from the insert as possible.

STEP 31 The use of mineral spirits will help remove any of the remaining adhesive from the insert. Allow the area to thoroughly dry.

CAUTION! Some cleaning products and or solvents contain harsh chemicals that can severely damage the intake insert and void warranty.

STEP 32 Using the back of your fingernail, rub the backing of the adhesive replacement pad to activate the catalyst, then remove the backing.

STEP 33 Apply the replacement adhesive pad to the intake insert where the other adhesive pad was. (PIC. 12)

STEP 34 Clean the area inside the fairing intake shown in PIC. 13, with an alcohol-cleaning pad and allow to thoroughly dry.

STEP 35 Using the back of your fingernail, rub the backing of the adhesive pad to activate the catalyst, then remove the backing.

STEP 36 Insert the vent insert into the fairing intake, press and hold in place for one (1) minute. Full bonding strength will occur in 24 hours.

STEP 37 Repeat STEP 29 through STEP 35 for the insert on the other side.

PIC. 9

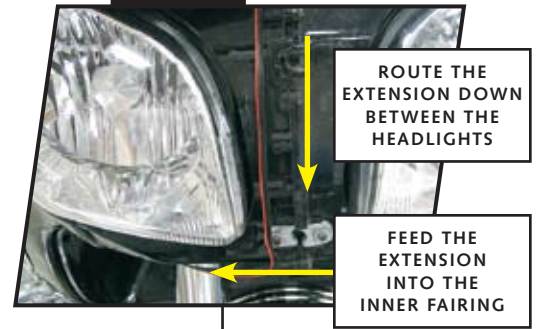

PIC. 10

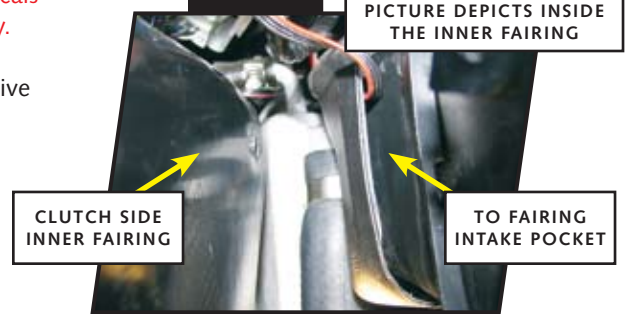

PIC. 11

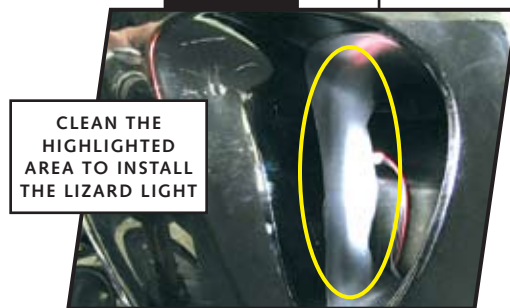

PIC. 12



PIC. 13



Ride On!